



For large-area, thin parts, e.g. for widening weld seams.



DESIGN

- Steel pole diameter 60 mm
- Design with linear (A) or offset (B) pole grid
- Larger systems as combination of several magnets
- Complete surface magnetically active also for direct placement
- Solid monoblock design with demagnetising cycle
- Robust and water-tight
- Protection rating IP 65
- Electro-permanent magnetic system for absolute safety in case of power failure
- System on the underside of the machine table magnetically isolated to protect drive and measuring systems
- Pole gap also available in solid brass on request (surcharge applies)
- Tapped hole grid M8 for optional pole shoes
- 12 mm wear layer on the pole plate
- Table fastening size 600 x 300 with 2 clamps on the edge
- Table fastening size 600 x 400 to 1000 x 500 with 4 clamps on the edge
- Table fastening size 1000 x 500 with through holes on request
- Electrical connection up to size 1000 x 500 with heavy-duty power connector, permanent connection for larger sizes
- Fastening with through holes on request
- Threaded holes for round poleshoes as an option (M)

RATED HOLDING FORCE

- When using pole raisers: 3200 N/pole
- For direct placement: 900 kN/m²

RATED VOLTAGE
360 V IMP

APPLICATION

- For chucking thinner plates, e.g. weld seam preparation and for milling of hard parts and higher alloyed materials. Please contact us for more information
- Amplified magnet system with demagnetising cycle, also suitable for hard milling
- Universal for a variety of different part geometries 5-side machining possible when using pole shoes (mobile and fixed) to create free space for tools
- Suitable for medium and large-surface systems
- Round version available on request

- For workpieces:
Min. thickness = 8 mm

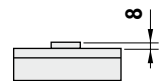

- For flat workpieces:
Min. size = 200 x 200 mm

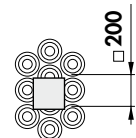

SCOPE OF DELIVERY

- Up to 525 mm width with 2 clamps, with 4 clamps for larger widths
- 3 m connecting cable, protective hose optionally possible
- Includes lifting plates
- Control and control unit not included (see SAV 876.17)
- Clamps

Version A – linear pole pattern

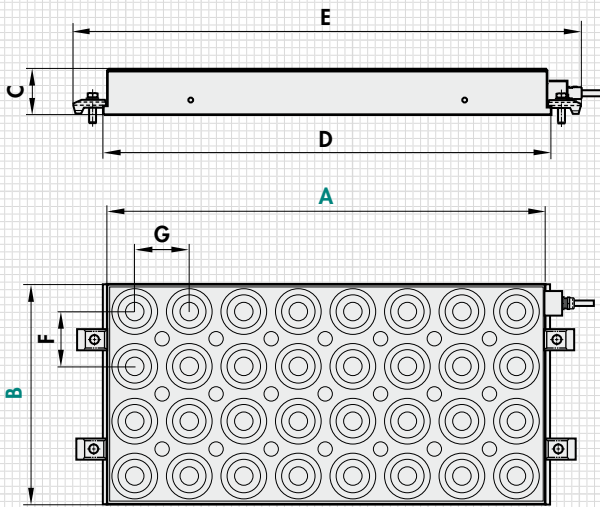

Version B – offset pole pattern

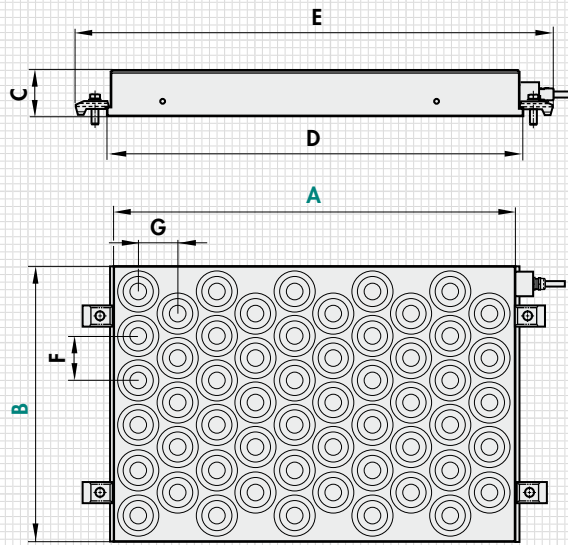

Dimensions for version A – linear pole pattern:

| mm | | | | | | | Qty. | daN | kg | A |
|------|-----|----|------|------|-----|-----|--------------|------------------------------------|--------|---------------------------|
| A | B | C | D | E | F | G | No. of poles | Total holding force on pole rounds | Weight | Control max. pul. Current |
| 600 | 300 | 80 | 616 | 720 | 100 | 100 | 18 | 5760 | 113.0 | 30 |
| 600 | 400 | 80 | 616 | 720 | 100 | 100 | 24 | 7680 | 151.0 | 30 |
| 800 | 400 | 80 | 816 | 920 | 100 | 100 | 32 | 10240 | 201.0 | 30 |
| 1000 | 500 | 80 | 1016 | 1120 | 100 | 100 | 50 | 16000 | 314.0 | 60 |
| 1200 | 600 | 80 | 1200 | | 100 | 100 | 72 | 23040 | 453.0 | 60 |
| 1600 | 600 | 80 | 1600 | | 100 | 100 | 96 | 30720 | 604.0 | 60 |
| 2000 | 600 | 80 | 2000 | | 100 | 100 | 120 | 38400 | 755.0 | 60x2 |
| 2000 | 800 | 80 | 2000 | | 100 | 100 | 160 | 51200 | 1006.0 | 60x2 |

Dimensions for version B – offset pole pattern:

| mm | | | | | | | Qty. | daN | kg | A |
|------|-----|----|------|------|-----|----|--------------|------------------------------------|--------|---------------------------|
| A | B | C | D | E | F | G | No. of poles | Total holding force on pole rounds | Weight | Control max. pul. Current |
| 600 | 350 | 80 | 616 | 720 | 100 | 85 | 22 | 7040 | 132.0 | 30 |
| 600 | 440 | 80 | 616 | 720 | 100 | 85 | 27 | 8640 | 166.0 | 30 |
| 800 | 440 | 80 | 816 | 920 | 100 | 85 | 37 | 11840 | 221.0 | 30 |
| 1000 | 525 | 80 | 1016 | 1120 | 100 | 85 | 57 | 18240 | 330.0 | 60 |
| 1200 | 610 | 80 | 1200 | | 100 | 85 | 80 | 25600 | 460.0 | 60x2 |
| 1600 | 610 | 80 | 1600 | | 100 | 85 | 108 | 34560 | 614.0 | 60x2 |
| 2000 | 610 | 80 | 2000 | | 100 | 85 | 136 | 43520 | 767.0 | 60x2 |
| 2000 | 800 | 80 | 2000 | | 100 | 85 | 175 | 56000 | 1006.0 | 60x3 |

ORDERING EXAMPLE

Designation SAV no. - A x B - version - number of poles - option - rated voltage
 Electro permanent magnetic chuck SAV 243.78 - 2000 x 800 - A - 160 - M - 360 V